



SMS 2A Sandbukta-Moss-Såstad

Norway /

Characteristics

BIM: 3d model coordination, drawings and BOQ extractions

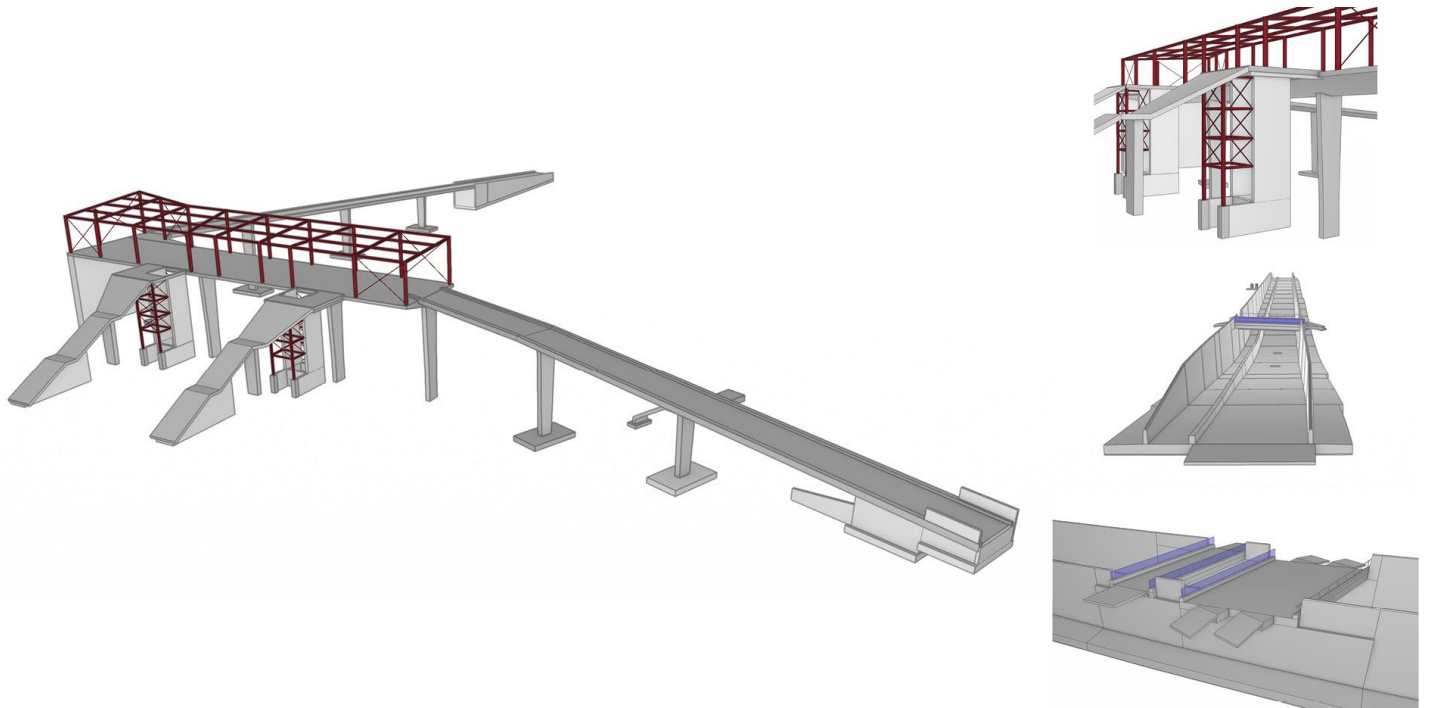

SMS 2A Sandbukta-Moss-Såstad project is part of the InterCity plan in the Østfold railway's western line. The project includes a 10.3 km, twin-track line, some of which will run above ground. The new line also requires the JV to build two tunnels, each longer than 2 km (Moss Tunnel and Carlberg Tunnel), two shorter cut-and-cover sections, a tunnel portal and a new train station with 800 m-long platforms and a pedestrian bridge.



C/ Barquillo 23, 2º | 28004 Madrid | España
T. (+34) 917 014 460 | F. (+34) 915 327 864
www.fhecor.com | fhecor@fhecor.es